

Revision Notes

R1 - BE-801C-C PART NUMBER UPDATED, FRAME UPDATED.			
APPA: TCF400	Drawn: RBATES	Checked: A.FEDERIGHI	Approved: G.P.LITH
R2 - VIEW A MATING FACE AND PINOUT TABLE UPDATED AS PER ECR CR-A204.			
APPA: TCF400	Drawn: RBATES	Checked: A.FEDERIGHI	Approved: G.P.LITH
			Date: 02/04/16

ITEM	PART NO	QTY	MODEL/DESCRIPTION
①	(4411)	1	BE-801C-C CAMERA ONLY
②	(#3244)	1	BE-89XC/BE-X0XC-BKT CAMERA BRACKET
③	(#3245)	1	BE-89XC/BE-X0XC-SS CAMERA SUNSHIELD
④	(#3246)	1	BE-2XXC/8XXC-FIX CAMERA FIXING PACK (NOT SHOWN)
⑤	(#3504)	1	BE-8X1-IG INSTALLATION GUIDE (NOT SHOWN)

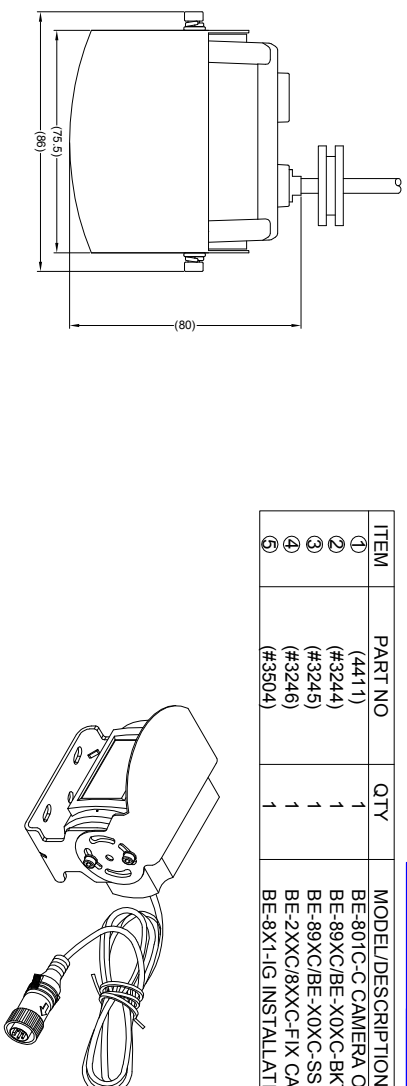

VIEW A

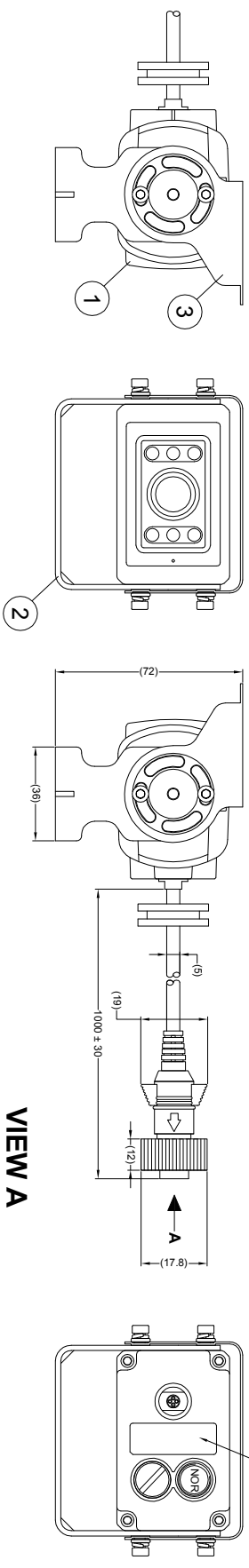

4 PIN MINI DIN MALE MATING FACE

PIN #	WIRE COLOUR	DESCRIPTION
1	YELLOW	VIDEO
2	RED	+12V
3	BLUE	NC
4	WHITE	AUDIO
5	BLACK/SHIELD	GND



- NOTES:**
1. REFER TO "PRODUCT SPECIFICATION" FOR MORE DETAILS.
 2. REFER TO COMPONENT DRAWINGS FOR COMPONENT DETAILS.
 3. ENSURE SELF-AMALGAMATING TAPE IS USED DURING INSTALLATION.
 4. FOR GIFTBOX LABEL REFER TO LATEST REVISION OF DRAWING BE-001218-XX-10.
 5. ANY CUSTOMER MODIFICATION OF THIS PRODUCT CAUSING SUBSEQUENT FAILURE IS NOT A LIABILITY OF BRIGADE ELECTRONICS PLC.

PROPRIETARY NOTICE

THIS DESIGN AND TECHNICAL INFORMATION APPEARING ON THIS DRAWING IS THE PROPERTY OF BRIGADE ELECTRONICS, AND IS DISCLOSED IN CONFIDENCE. IT IS NOT TO BE COPIED, REPRODUCED, REVEALED TO OR EXPLOITED BY OTHERS, EITHER IN WHOLE OR IN PART WITHOUT THE EXPRESS WRITTEN CONSENT OF BRIGADE ELECTRONICS.

BRIGADE
www.brigade-electronics.com

<p>Angle of Projection Third Angle</p>	<p>Assembly PI Approval</p>		<p>Approved by DKERAL</p>	<p>Checked by M.BUTLER</p>	<p>Drawn by J.NEWMAN</p>
	<p>Units mm</p>	<p>Scale N/A</p>	<p>Released 11/10/10</p>	<p>Assembly Ref</p>	<p>Status RELEASED</p>
<p>BE-801C</p>					
<p>BE-001267-02-10</p>					